

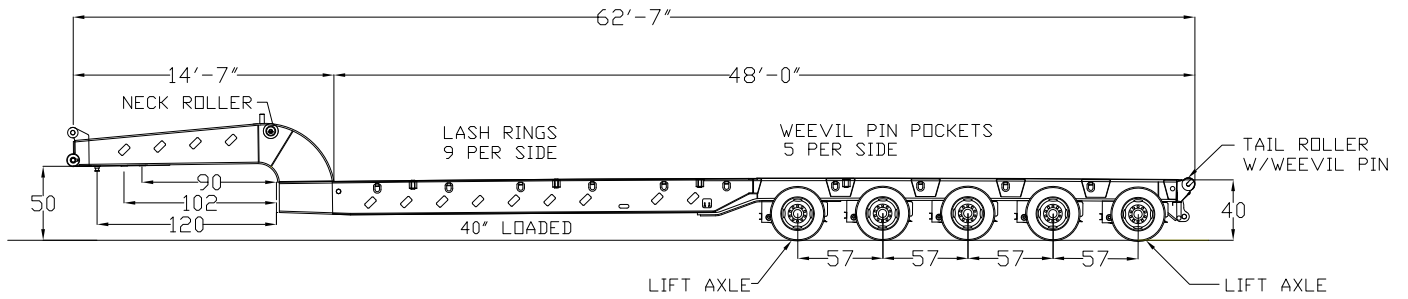

75 TON FIXED GOODNECK OIL FIELD TRAILER



75 TON CAPACITY
G/NECK SET UP FOR FLIP
REMOVABLE 2" KINGPIN

16.5 X 7" BRAKES
25,000 LB CAPACITY AXLES-3/4"
SPRING BRAKES-2 AXLES

255/70R 22.5 (LRH) TIRES
8.25 X 22.5 STEEL DISC WHEELS
AIR RIDE SUSPENSION WITH
AUTO AND MANUAL CONTROLS

8-5/8" X 7/8"WALL- ROLLING TAIL
DOUBLE OVER LOAD ROLLERS
DOUBLE SPHERICAL ROLLER BEARINGS
H.D. PIPE BUMPER

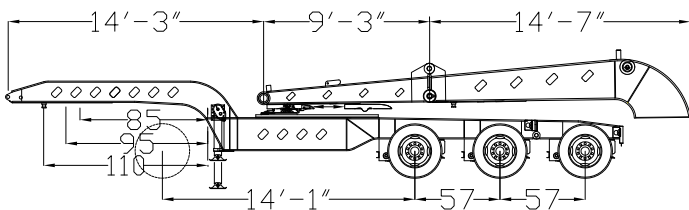

40 TON CAPACITY JEEP
OILFIELD G/N WITH FLIP NECK
REMOVABLE 2" KINGPIN

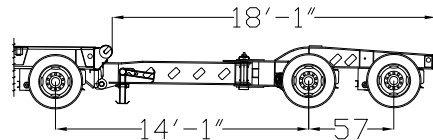

25 TON STINGER
LANDING GEAR FOR STAND
PIVOT FOR STEERING
AIR RIDE SUSPENSION WITH
AUTO AND MANUAL CONTROLS